

Brushless DC Pump



PRODUCT CATALOG

in|Solar[®]
Pumps
.com

Home for all your micro-DC pump needs!

Overview

Micro centrifugal pumps powered by brushless DC motors. They are designed to be cool, quiet, compact and light weight products. A variety of features, including a seal-less design to prevent leakage forever, wide range of working voltage, stable performance, long life time, enable the pumps to meet a full spectrum of user's needs, with emphasis on easy of installation, operation and maintenance.

Features

- Advanced magnetic driving technology for static-seal, without any leakage forever
- The pump can continuous working 24 hours, long lifetime about 20,000 hours
- Endurance graphite bearing, high precision, low noise and durable
- 100°C high temperature resistance
- Wide operate voltage range available
- Submersible, RPM, PWM and power by solar panel can be customized

Typical Applications

Auto Pump

- automation equipment
- auto cooling system
- electric motorcycle

Solar Pump

- water circulation for solar system
- solar applications
- solar water heater

Food Grade Pump

- drinking machine
- beverage/water dispenser
- coffee machine

Mechanical equipment and chemical industry

- environmental protection equipment
- medical equipment
- sewage purifier
- fuel cell
- irrigation

Home Appliance

- electric storage water heater
- instant water heater
- air source water heater
- linked to boiler
- PC water cooling system
- sanitary product
- washing machine
- air condition
- the fountain
- air purifier
- chiller
- residential humidifier
- aroma diffuser

A3

Typical Applications

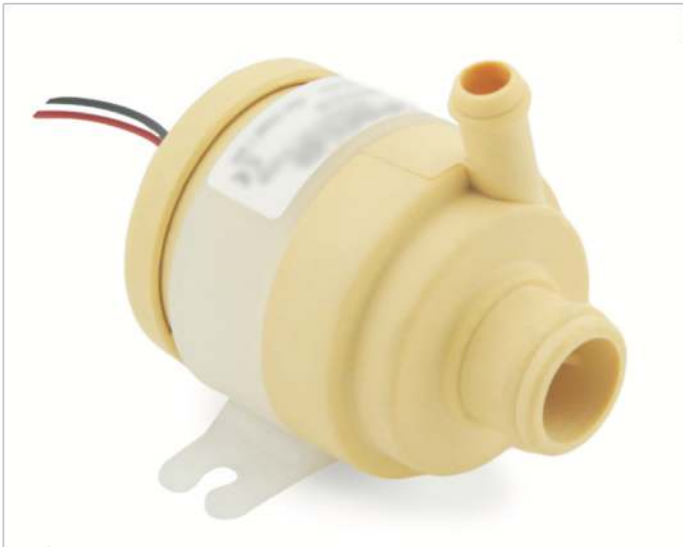

- water dispenser/water coolers
- coffee maker/coffee machine
- beverage dispenser/juice machine
- water purifier
- tea maker
- milk dispenser
- the fountain

Specification

Model	Product Code	Max Flow Rate (L/Min)	Voltage Scope (DC)	Current (A)	Max Water Head (M)	Power (W)
A3	A3-A12-0302	2.75L	12VDC	0.4	1.5	5

Note: 1.pump itself meet /F,food grade 2.normal type liquid $\leq 70^{\circ}\text{C}$, /H high temperature type liquid $\leq 105^{\circ}\text{C}$ can be customized as: 0302/H 3. /S submersible type can be customized, if submersible liquid should be $\leq 50^{\circ}\text{C}$ 4. /FG(RPM) signal wire can be customized.

Curve&Dimension

A3 PERFORMANCE

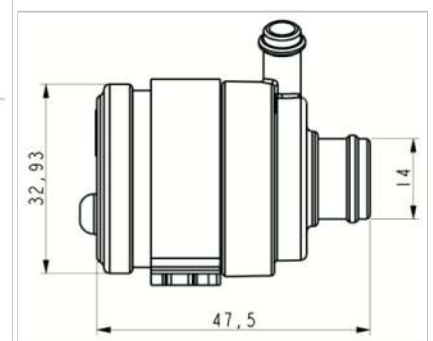
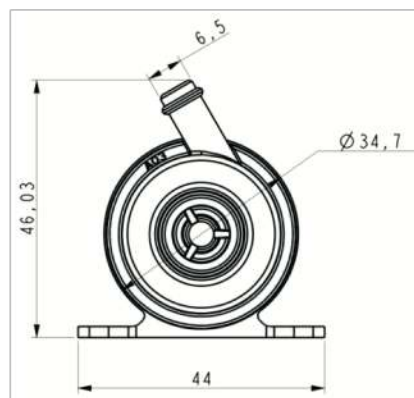
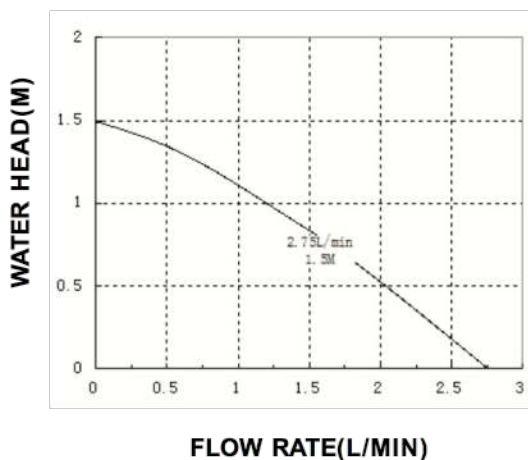

B3

Typical Applications



- coffee maker/coffee machine
- water purifier/water dispenser
- beverage dispenser/juice machine
- water coolers
- milk dispenser
- tea maker

Specification

Model	Product Code	Max Flow Rate (L/M)	Rated Voltage (DC)	Current (A)	Max Water Head (M)	Power (W)
B3	B3-A12-0602	6.5L	12VDC	0.4	2.5	5
	B3-A24-0602	6.5L	24VDC	0.2	2.5	5

Note: 1.pump itself meet /F,food grade 2.normal type liquid $\leq 70^{\circ}\text{C}$, /H high temperature type liquid $\leq 105^{\circ}\text{C}$ can be customized as: 0602/H 3. /S submersible type can be customized, if submersible liquid should be $\leq 50^{\circ}\text{C}$ 4. /FG(RPM) signal wire can be customized.

Curve & Dimension

B3 PERFORMANCE

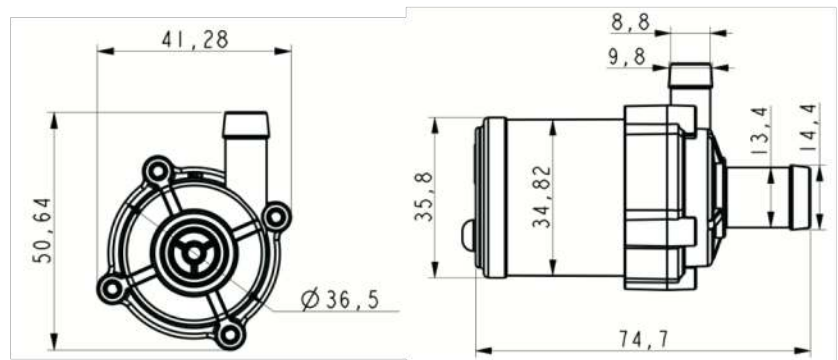
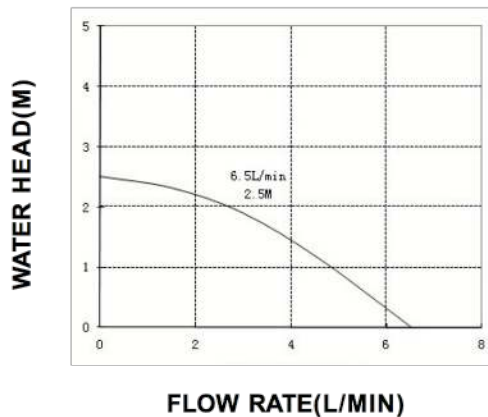

B9

Typical Applications



- water heating mattress
- home circulating systems
- computer cooling circulation
- liquid transfer
- general purpose pumping

Specification

Model	Product Code	Max Flow Rate (L/Min)	Voltage Scope (DC)	Current (A)	Max Water Head (M)	Power (W)
B9	B9-A12-0601	6L	12VDC	0.25	1.2	3
Ultra quiet suspension rotor $\leq 28\text{dB}$						
Note: 1. liquid $\leq 70^{\circ}\text{C}$ 2. FG(RPM) singal wire can be customized						

Curve&Dimension

B9 PERFORMANCE

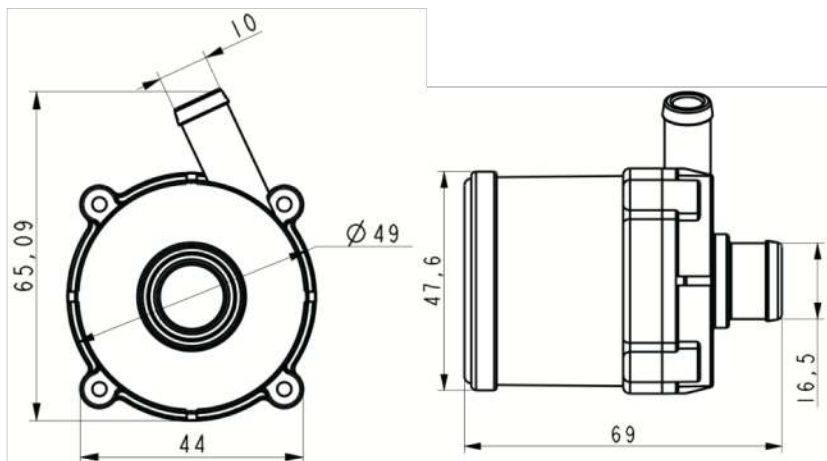
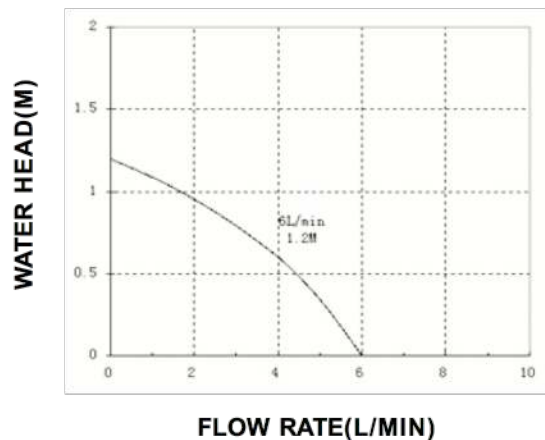

B10

Typical Applications

Pump A



Pump B



- water dispenser, water cooler
- carbonation, coffee maker,
- beverage dispenser
- air-conditioner drain
- chillers, cooling circulation,
- home appliance
- solar applications
- instant water heater

Specification

Model	Product Code	Max Flow Rate (L/M)	Rated Voltage (DC)	Current (A)	Max Water Head (M)	Power (W)
B10-A	B10-A12-0703	7L	12VDC	0.6	3	7
	B10-A12-0905	9L	12VDC	1.4	5	16.8
	B10-A24-0703	7L	24VDC	0.4	3	10
	B10-A24-0905	9L	24VDC	0.6	5	15
	B10-A24-1208	12L	24VDC	1.3	8	31.2
B10-B	B10-B12-0703	7L	12VDC	0.6	3	7
	B10-B12-0905	9L	12VDC	1.4	5	16.8
	B10-B24-0703	7L	24VDC	0.4	3	10
	B10-B24-0905	9L	24VDC	0.6	5	15
	B10-B24-1208	12L	24VDC	1.3	8	31.2

Note: 1.pump itself meet: /F,food grade 2. normal type liquid $\leq 70^{\circ}\text{C}$, /H high temperature type liquid $\leq 105^{\circ}\text{C}$ can be customized for items of 0703/H, 0905/H. 3. /S submersible type can be customized, if submersible liquid should be $\leq 50^{\circ}\text{C}$ 4. /PV type by solar panel driven directly can be customized as: 12V (suit for solar panel 7V~24V), 24V (suit for solar panel 14V~32V). 5. FG(RPM) signal wire can be customized 6. PWM frequency speed control or 0~5V speed control can be customized.

Curve

**B10 (PUMP A AND PUMP B)
PERFORMANCE**

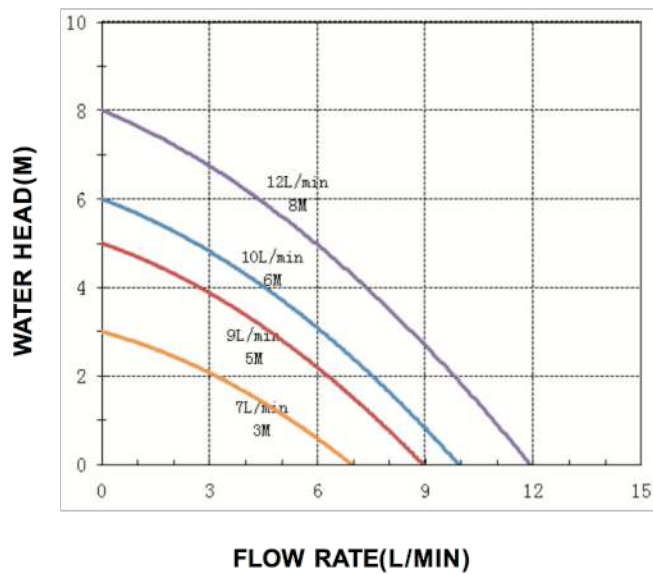

Pump A



Pump B



Dimension

Pump A

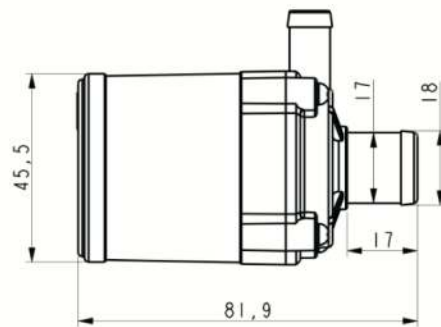
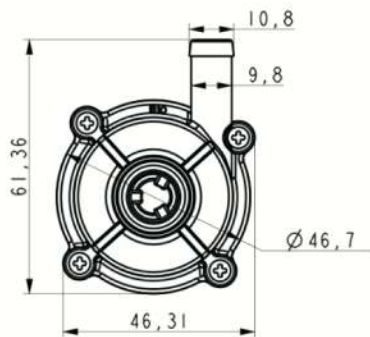

Pump B

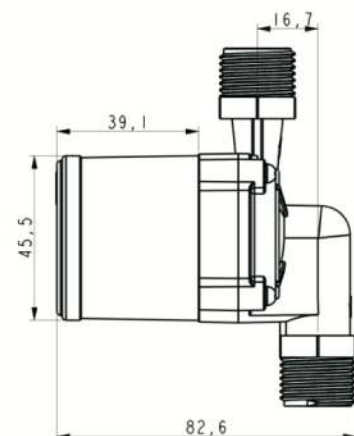
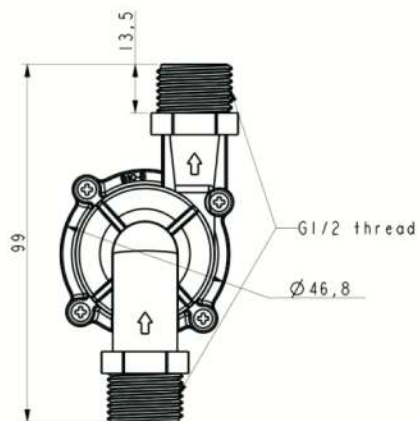

C1



Pump A



Pump B



Pump C

Typical Applications

- instant water heater, air can heater, constant temperature gas heater
- water dispenser, food pump, carbonation, beverage dispenser
- water cooling circulation, chillers
- boosting applications
- solar applications

Specification

Model	Product Code	Max Water Flow (L/Min)	Rated Voltage(DC)	Rated Current (A)	Max Water Head(M)	Rated Power(W)
C1-A	C1-A12-1706	17L	12VDC	2.2	6	26.4
	C1-A12-2008	20L	12VDC	2.8	8	34
	C1-A24-1908	19L	24VDC	1.5	8	36
	C1-A24-2411	24L	24VDC	2	11	48
C1-B	C1-B12-1606	16L	12VDC	2.2	6	26.4
	C1-B12-1908	19L	12VDC	2.8	8	34
	C1-B24-1808	18L	24VDC	1.5	8	36
	C1-B24-2211	22L	24VDC	2	11	48
C1-C	C1-C12-1706	17L	12VDC	2.2	6	26.4
	C1-C12-2008	20L	12VDC	2.8	8	34
	C1-C24-1908	19L	24VDC	1.5	8	36
	C1-C24-2411	24L	24VDC	2	11	48

Note: 1.pump itself meet: /F,food grade 2. normal type liquid $\leq 70^{\circ}\text{C}$, /H high temperature type liquid $\leq 105^{\circ}\text{C}$ can be customized for items of 12V:1706/H,1606/H & 24V:1908/H,1808/H. 3. /S submersible type can be customized, if submersible liquid should be $\leq 50^{\circ}\text{C}$ 4. /PV type by solar panel driven directly can be customized as: 12V (suit for solar panel 7V~24V), 24V (suit for solar panel 14V~32V). 5. FG(RPM) signal wire can be customized 6. PWM frequency speed control or 0~5V speed control can be customized.

Curve

**C1 (PUMP A And Pump C)
PERFORMANCE**

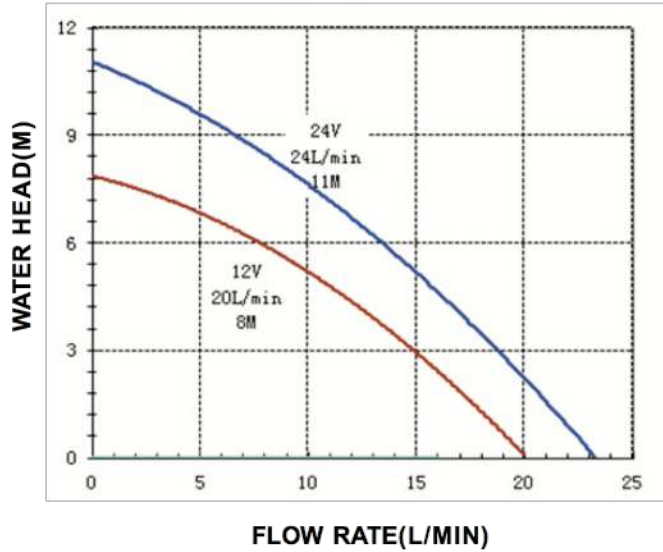

C1(PUMP B) PERFORMANCE

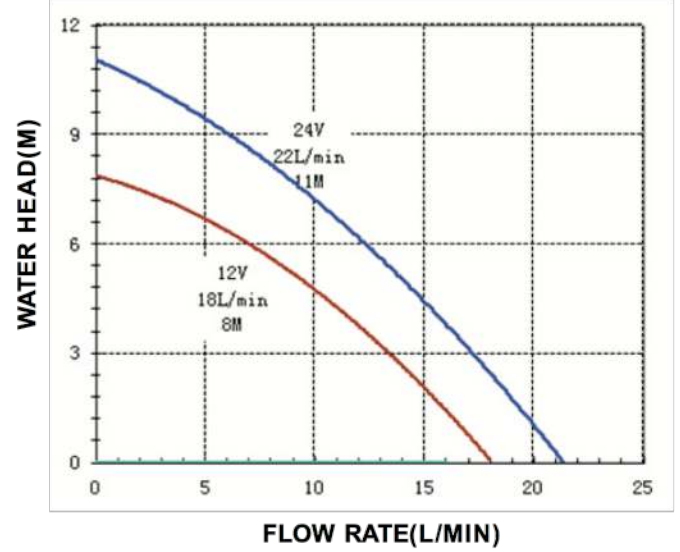

Dimension

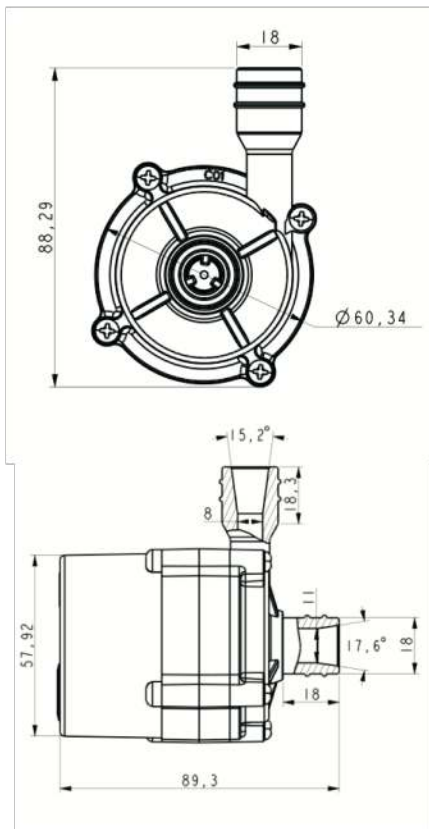

Pump A

(circle nozzles $\varnothing 18\text{mm}/\varnothing 18\text{mm}$)

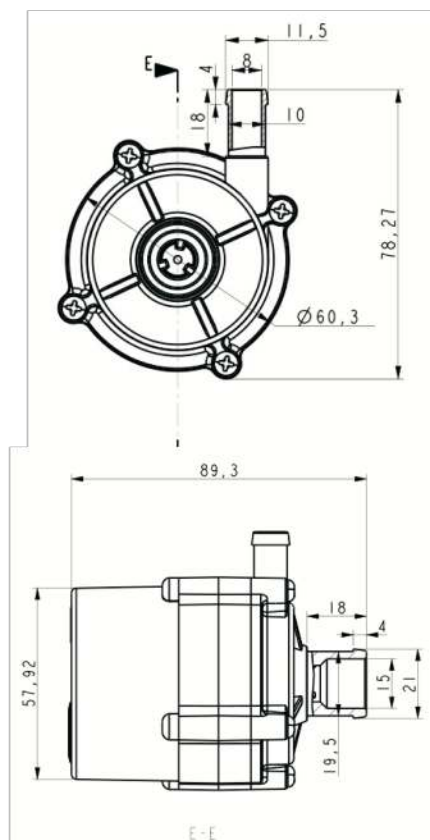

Pump B

(barb nozzles $\varnothing 19.5\text{mm}/\varnothing 10\text{mm}$)

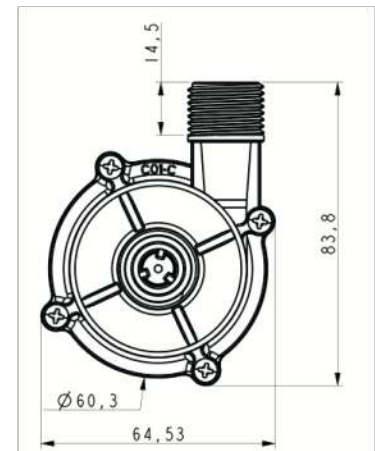

Pump C

(thread nozzles G1/2)

More Specializing Brushless DC Circulation Pump Series

TD-A



TD-B



High Efficiency Ultra Quiet 26dB Computer Circulation Pump

S5



D5



Solar Hot Water Circulation Pump

A5



A6



Car /Truck /Bus /Yacht Circulation Pump

Home for all your micro-DC pump needs!